

Fairview Station Area

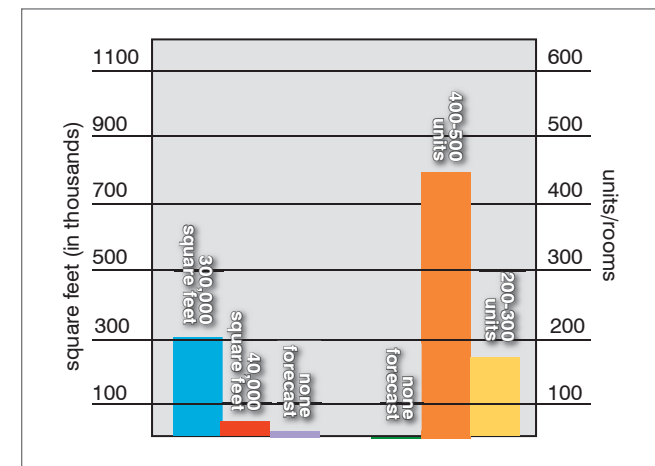

FAIRVIEW MARKET POTENTIAL

The Fairview Station Area Plan estimates an additional 300,000 SF of office space, 40,000 SF of retail and roughly 600 housing units within a 1/4-mile radius of the station platform. The Fairview SAP forecasts less retail space than all other station areas and calls for an expansion of the existing office campus east of Fairview westward into the Prior/University study area.

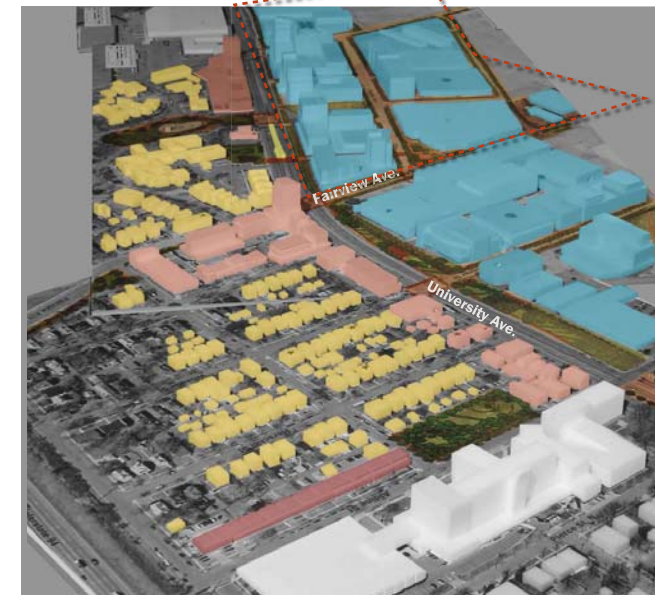